

FIRE EXTINGUISHER STORAGE TROLLEY-SINGLE(COLLAPSIBLE & DETACHABLE)-INSTALLATION SEQUENCES

DATE:07.10.21

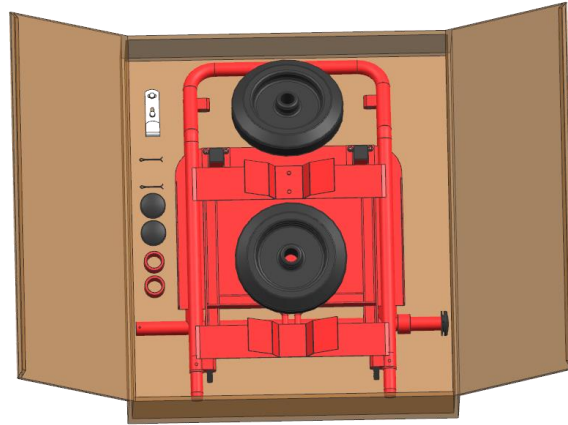

CARTON INNER SIZE FOR 1 NO.
SIZE:L-655 x B-575 x H-175

CARTON INNER SIZE FOR 2 NOS.
SIZE:L-765 x B-575 x H-240

NOTE:-INTERNAL SIZE INCLUDING 10mm CLEARANCE FROM ALL THE SIDES FOR PACKING MATERIAL.

STEP-01

OPEN THE TROLLEY CARTON.

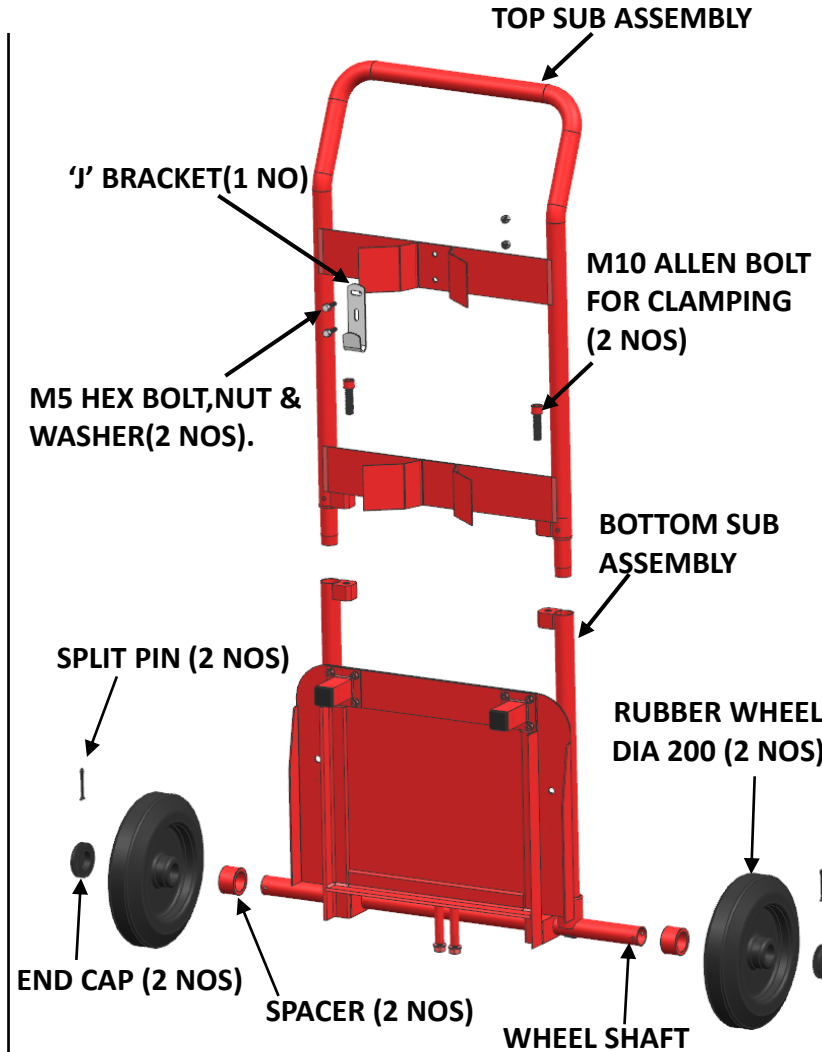

STEP-02

TAKE OUT ALL TROLLEY PARTS.

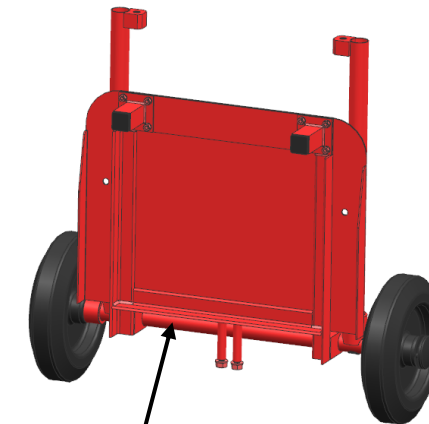

BOTTOM SUB ASSEMBLY

STEP-03

1. ASSEMBLE SPACER, RUBBER WHEEL & END CAP ON BOTH SIDE OF WHEEL SHAFT(AS SHOWN IN IMAGE).
2. LOCK END CAP BY INSERTING SPLIT PIN.

FIRE EXTINGUISHER STORAGE TROLLEY-SINGLE(COLLAPSIBLE & DETACHABLE)-INSTALLATION SEQUENCES

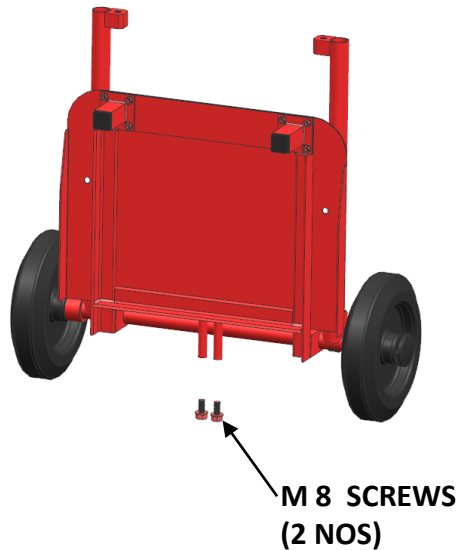

STEP-04

REMOVE M 8 SCREW FROM
SIDE SUPPORT GUARD.



STEP-05

UNFOLD BASE PLATE DOWNWARD
(AS SHOWN IN IMAGE).



STEP-06

UNFOLD BOTH THE SIDE SUPPORT
GUARD & PUT M 8 SCREW FROM
BOTTOM SIDE (AS SHOWN IN IMAGE).

FIRE EXTINGUISHER STORAGE TROLLEY-SINGLE(COLLAPSIBLE & DETACHABLE)-INSTALLATION SEQUENCES

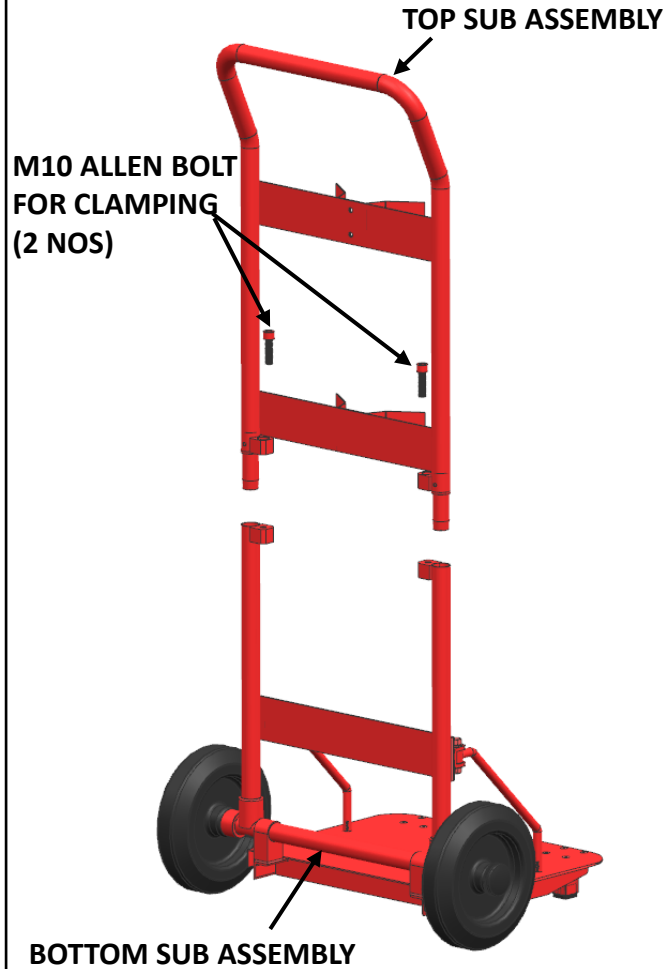

STEP-07

ASSEMBLE TOP & BOTTOM SUB ASSEMBLIES WITH M10 ALLEN BOLTS(2 NOS)-AS SHOWN IN IMAGE.

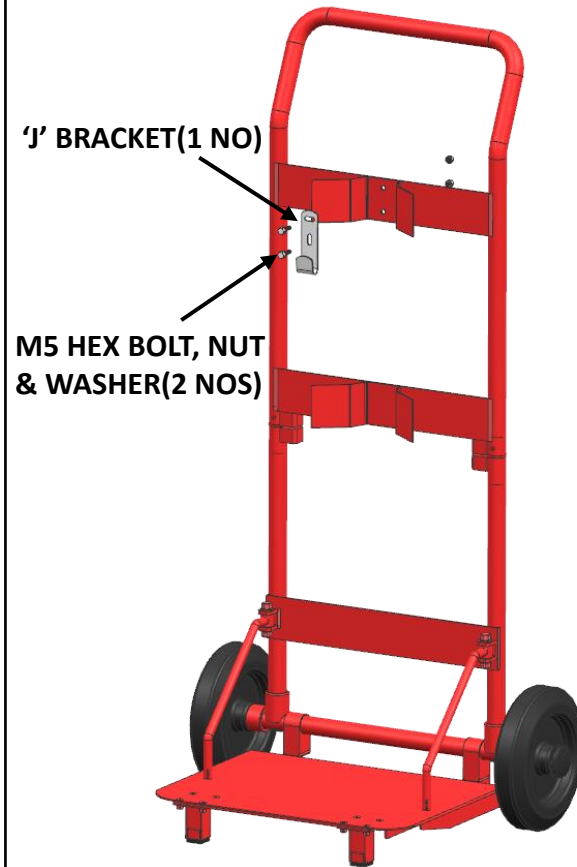

STEP-08

ASSEMBLE 'J' BRACKET(1 NO) WITH M5 BOLT, WASHER & NUT-AS SHOWN IN IMAGE.



STEP-09

FINAL ASSEMBLED TROLLEY.

FIRE EXTINGUISHER STORAGE TROLLEY-DOUBLE(COLLAPSIBLE & DETACHABLE)-INSTALLATION SEQUENCES

DATE:07.10.21

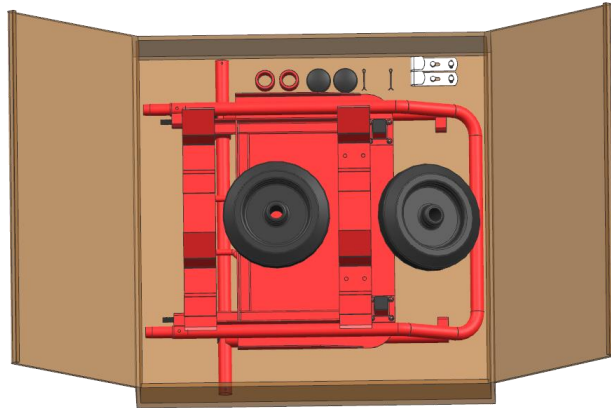

CARTON INNER SIZE FOR 1 NO.
SIZE:L-655 x B-655 x H-175

CARTON INNER SIZE FOR 2 NOS.
SIZE:L-765 x B-655 x H-240

NOTE:-INTERNAL SIZE INCLUDING 10mm CLEARANCE FROM ALL THE SIDES FOR PACKING MATERIAL.

STEP-01

OPEN THE TROLLEY CARTON.

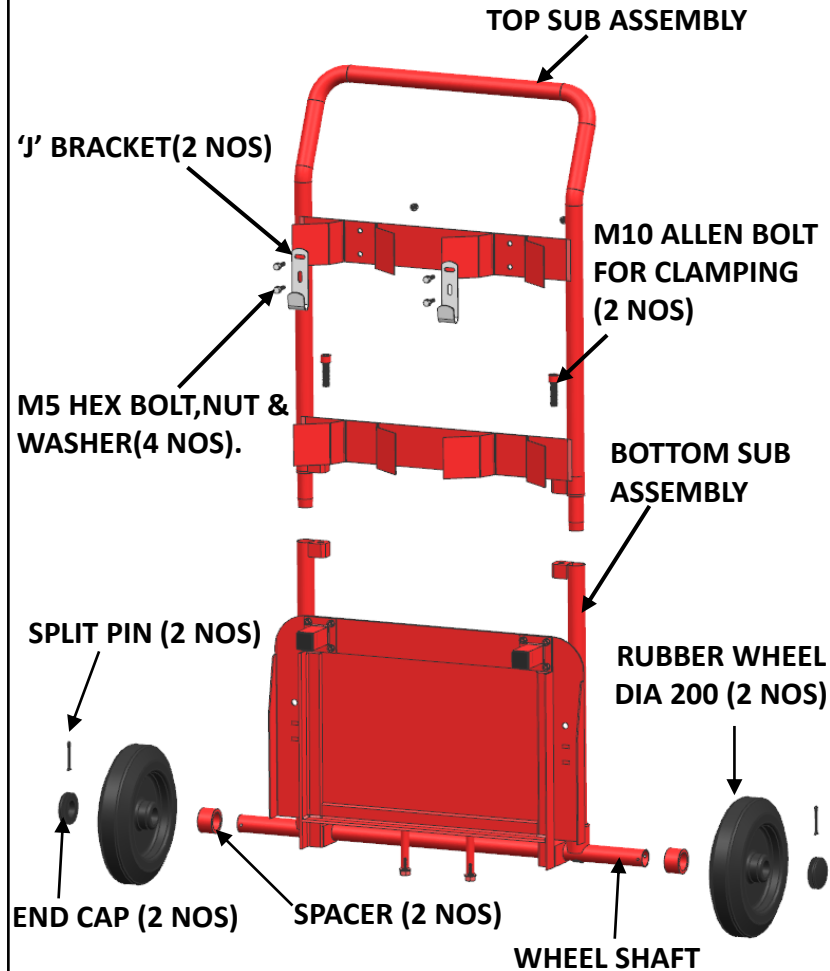

STEP-02

TAKE OUT ALL TROLLEY PARTS.

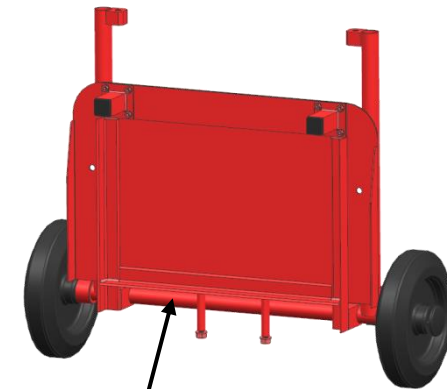

BOTTOM SUB ASSEMBLY

STEP-03

1. ASSEMBLE SPACER, RUBBER WHEEL & END CAP ON BOTH SIDE OF WHEEL SHAFT(AS SHOWN IN IMAGE).
2. LOCK END CAP BY INSERTING SPLIT PIN.

FIRE EXTINGUISHER STORAGE TROLLEY-DOUBLE(COLLAPSIBLE & DETACHABLE)-INSTALLATION SEQUENCES

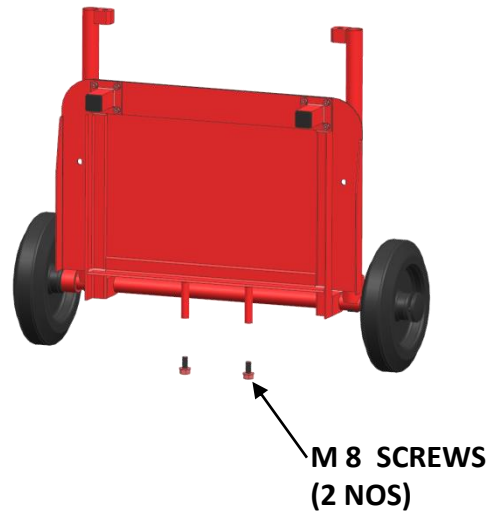

STEP-04

REMOVE M 8 SCREW FROM
SIDE SUPPORT GUARD.



STEP-05

UNFOLD BASE PLATE DOWNWARD
(AS SHOWN IN IMAGE).



STEP-06

UNFOLD BOTH THE SIDE SUPPORT
GUARD & PUT M 8 SCREW FROM
BOTTOM SIDE (AS SHOWN IN IMAGE).

FIRE EXTINGUISHER STORAGE TROLLEY-DOUBLE(COLLAPSIBLE & DETACHABLE)-INSTALLATION SEQUENCES

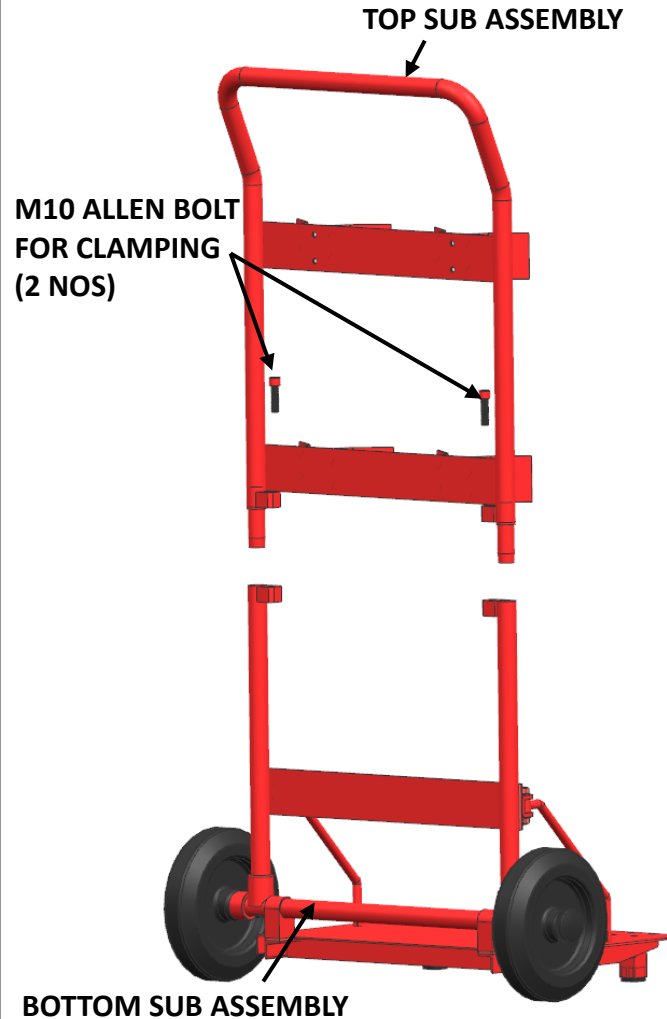

STEP-07

ASSEMBLE TOP & BOTTOM SUB ASSEMBLIES WITH M10 ALLEN BOLTS(2 NOS)-AS SHOWN IN IMAGE.



STEP-08

ASSEMBLE 'J' BRACKET(2 NOS) WITH M5 BOLT, WASHER & NUT-AS SHOWN IN IMAGE.

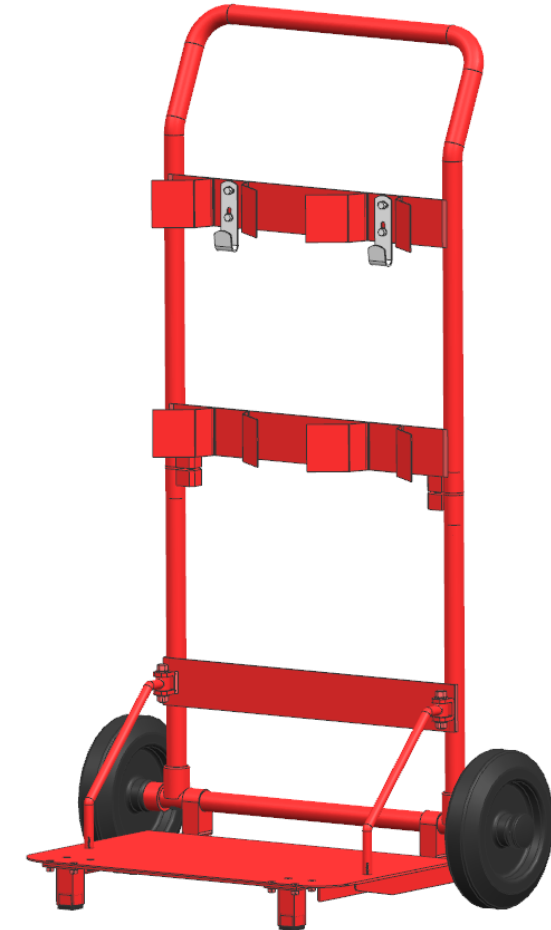

STEP-09

FINAL ASSEMBLED TROLLEY.

FIRE EXTINGUISHER STORAGE TROLLEY-TRIPPLE(COLLAPSIBLE & DETACHABLE)-INSTALLATION SEQUENCES

DATE:07.10.21

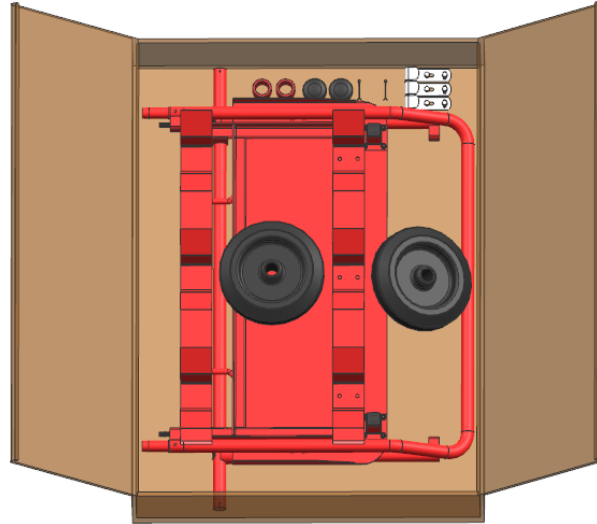

CARTON INNER SIZE FOR 1 NO.
SIZE:L-890 x B-655 x H-175

CARTON INNER SIZE FOR 2 NOS.
SIZE:L-890 x B-765 x H-240

NOTE:-INTERNAL SIZE INCLUDING 10mm CLEARANCE FROM ALL THE SIDES FOR PACKING MATERIAL.

STEP-01

OPEN THE TROLLEY CARTON.

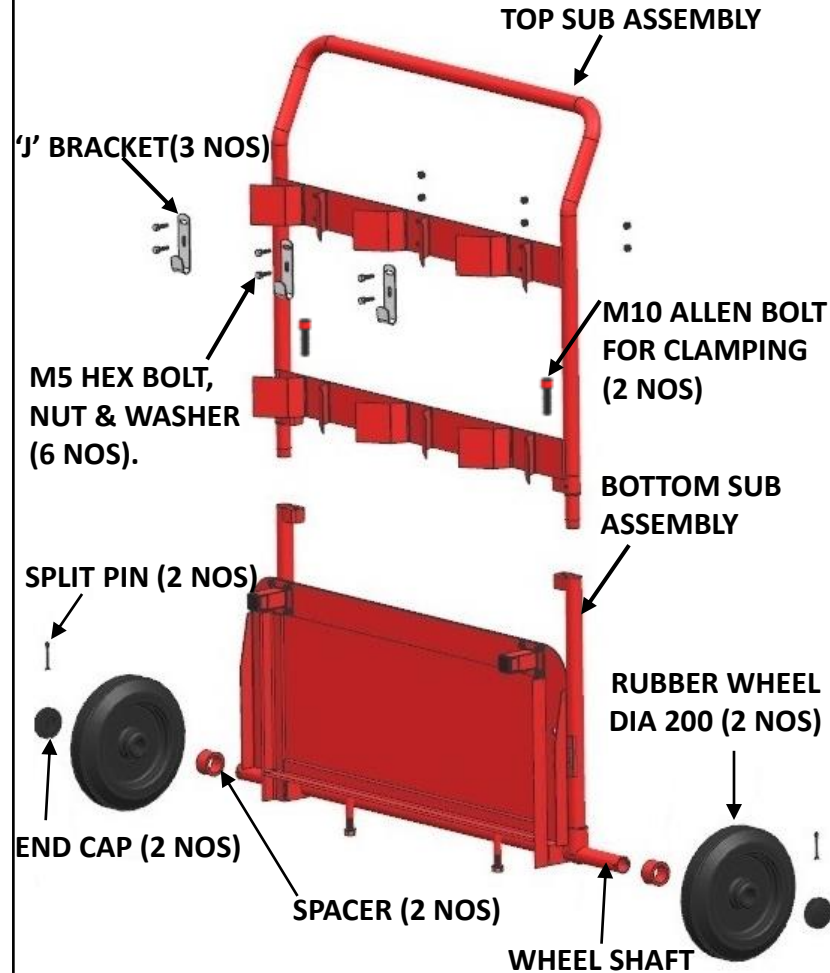

STEP-02

TAKE OUT ALL TROLLEY PARTS.

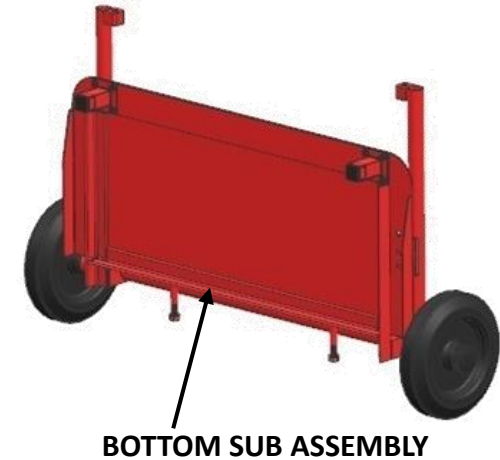

STEP-03

1. ASSEMBLE SPACER, RUBBER WHEEL & END CAP ON BOTH SIDE OF WHEEL SHAFT(AS SHOWN IN IMAGE).
2. LOCK END CAP BY INSERTING SPLIT PIN.

FIRE EXTINGUISHER STORAGE TROLLEY-TRIPPLE(COLLAPSIBLE & DETACHABLE)-INSTALLATION SEQUENCES



M 8 SCREWS
(2 NOS)

STEP-04

REMOVE M 8 SCREW FROM
SIDE SUPPORT GUARD.



BASE PLATE

STEP-05

UNFOLD BASE PLATE DOWNWARD
(AS SHOWN IN IMAGE).



BOTTOM SUB ASSEMBLY

STEP-06

UNFOLD BOTH THE SIDE SUPPORT
GUARD & PUT M 8 SCREW FROM
BOTTOM SIDE (AS SHOWN IN IMAGE).

FIRE EXTINGUISHER STORAGE TROLLEY-TRIPPLE(COLLAPSIBLE & DETACHABLE)-INSTALLATION SEQUENCES

M10 ALLEN BOLT
FOR CLAMPING
(2 NOS)

TOP SUB ASSEMBLY



BOTTOM SUB ASSEMBLY

STEP-07

ASSEMBLE TOP & BOTTOM SUB ASSEMBLIES WITH M10 ALLEN BOLTS(2 NOS)-AS SHOWN IN IMAGE.

'J' BRACKET(3 NOS)

M5 HEX BOLT,
NUT & WASHER
(6 NOS)



STEP-08

ASSEMBLE 'J' BRACKET(3 NOS) WITH M5 BOLT, WASHER & NUT-AS SHOWN IN IMAGE.



TROLLEY SIZE: L-878 x B-419 x H-1100

STEP-09

FINAL ASSEMBLED TROLLEY.

FIRE SAFETY POINT TROLLEY-CONTRACTOR STAND(COLLAPSIBLE & DETACHABLE)- INSTALLATION SEQUENCES

DATE:07.10.21

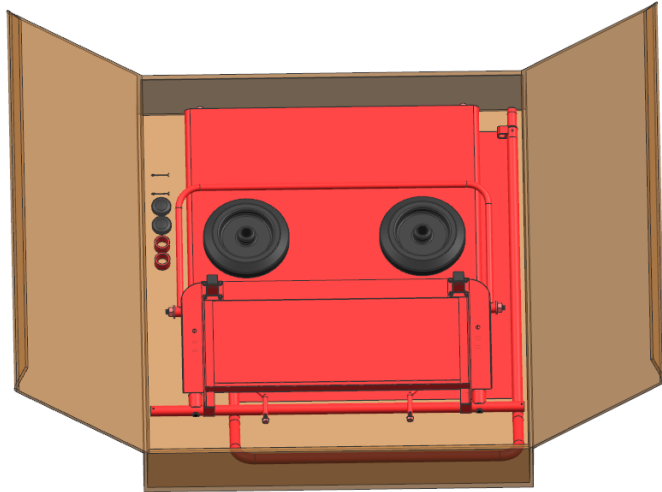

CARTON INNER SIZE FOR 1 NO.
SIZE:L-995 x B-890 x H-175

CARTON INNER SIZE FOR 2 NOS.
SIZE: L-995 x B-890 x H-290

NOTE:-INTERNAL SIZE INCLUDING 10mm CLEARANCE FROM ALL THE SIDES FOR PACKING MATERIAL.

STEP-01

OPEN THE TROLLEY CARTON.

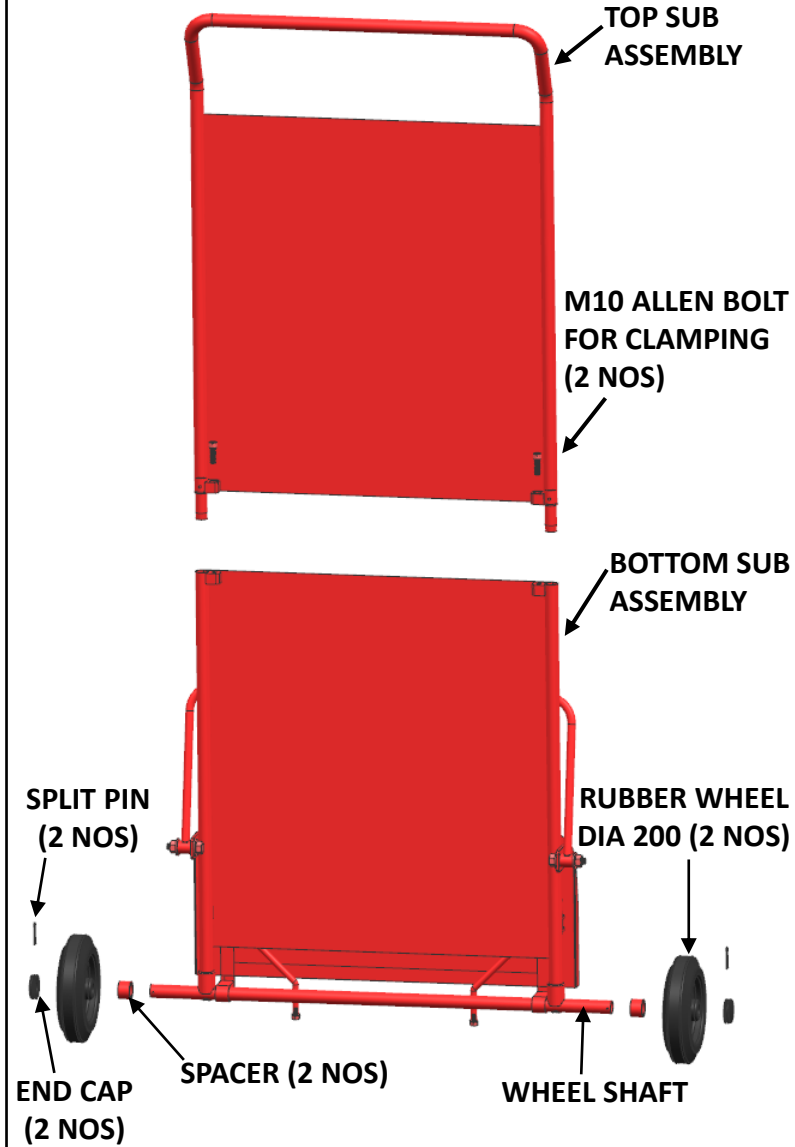

STEP-02

TAKE OUT ALL TROLLEY PARTS.



BOTTOM SUB ASSEMBLY

STEP-03

1. ASSEMBLE SPACER, RUBBER WHEEL & END CAP ON BOTH SIDE OF WHEEL SHAFT(AS SHOWN IN IMAGE).
2. LOCK END CAP BY INSERTING SPLIT PIN.

**FIRE SAFETY POINT TROLLEY-CONTRACTOR STAND(COLLAPSIBLE & DETACHABLE)-
INSTALLATION SEQUENCES**



STEP-04

REMOVE M 8 SCREW FROM
SIDE SUPPORT GUARD.



STEP-05

UNFOLD BASE PLATE DOWNWARD
(AS SHOWN IN IMAGE).

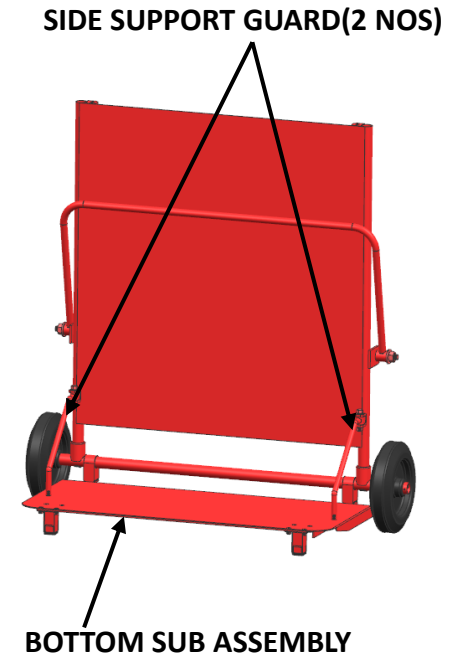

STEP-06

UNFOLD BOTH THE SIDE SUPPORT
GUARD & PUT M 8 SCREW FROM
BOTTOM SIDE (AS SHOWN IN IMAGE).

**FIRE SAFETY POINT TROLLEY-CONTRACTOR STAND(COLLAPSIBLE & DETACHABLE)-
INSTALLATION SEQUENCES**

PIPE-FRONT
SUPPRT GUARD

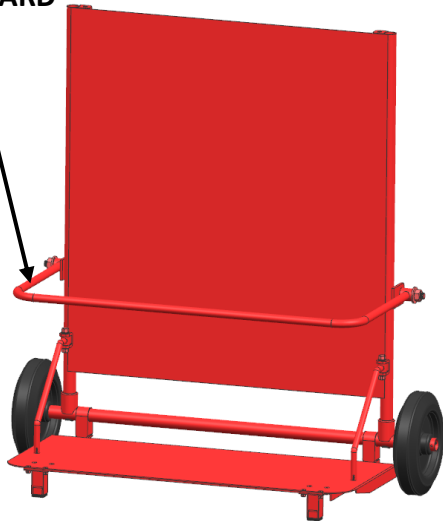

STEP-07

UNFOLD PIPE-FRONT SUPPORT
GUARD DOWNWARD (AS SHOWN
IN IMAGE).

TOP SUB
ASSEMBLY

M10 ALLEN BOLT
FOR CLAMPING
(2 NOS)

BOTTOM SUB
ASSEMBLY

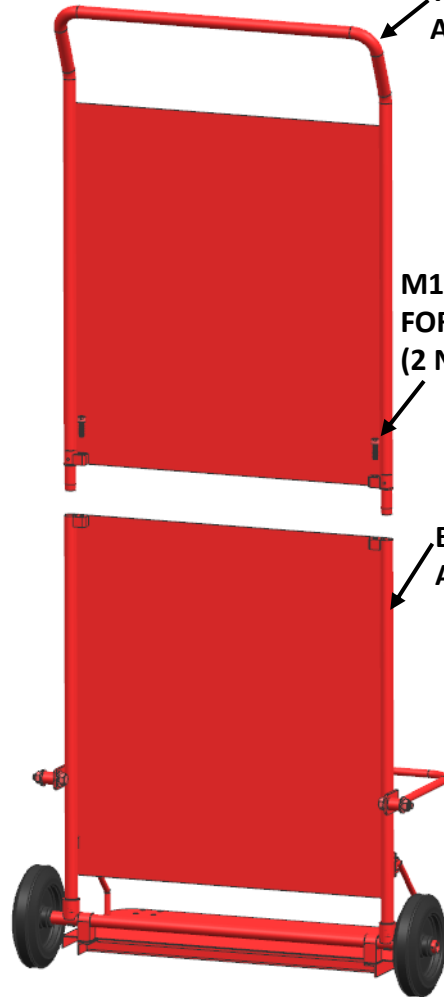

STEP-08

ASSEMBLE TOP & BOTTOM SUB
ASSEMBLIES WITH M10 ALLEN
BOLTS(2 NOS)-AS SHOWN IN IMAGE.

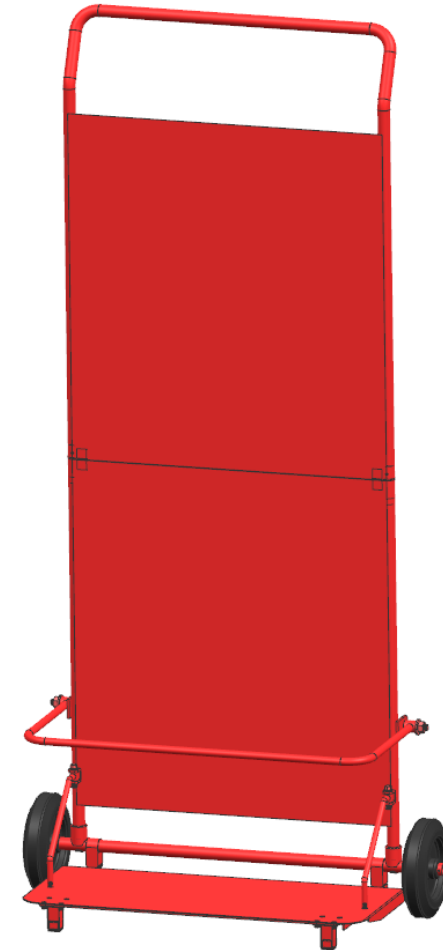

TROLLEY SIZE: L-878 x B-419 x H-1825

STEP-09

FINAL ASSEMBLED TROLLEY.